

**ERATE 470 FORM #160006418 REQUEST AND
REQUEST FOR PROPOSAL (RFP) FOR:
Wireless Project
Creighton Community Schools**

CREIGHTON COMMUNITY SCHOOLS is seeking proposals for the upcoming Funding Year 16-17 round of E-Rate. The district is soliciting proposals for the purchase and installation of wireless network electronics. All services are to be completed within the guidelines and regulations for local, state, and the federal E-rate program.

SERVICES AND HARDWARE REQUESTED:

- **Network Switches, Wireless Access Points, Wireless Controller, Ethernet and Fiber Network Cabling, Caching Server, UPS, and Equipment Racks.**

CCS is one campus which consists of about 30 classrooms, multiple computer labs, multiple gymnasiums, multiple commons areas, and multiple libraries. The Main Distribution Frame (MDF) is located in the JR/SR High School in the room labeled Nurse. An Intermediate Distribution Frames (IDF) is located in the JR/SR High School just to the east of the room labeled 506, which connects to the MDF via copper ethernet. Another IDF is located in the Elementary School in a room to the north of the Gym and to the east of the restrooms, which connects back to the previous mentioned IDF via copper ethernet . A third IDF is located in the JR/SR High School in the room labeled Mac Lab, which connects to the MDF via copper ethernet.

The successful bidder(s) will be responsible for qualifying for and adhering to the Federal E-Rate program. Items not eligible for E-Rate must be itemized in the bid. Prices must be held firm for the duration of the E-Rate Year. These projects and services depend on partial funding from the E-rate program and should be completed within the funding year.

- **Applicant expects each Service Provider to make themselves thoroughly familiar with any rules or regulations regarding the E-rate program.**
- **All contracts entered into as a result of this RFP will be contingent upon the specific funding of the FRN at the percentage rate submitted.**

- The maximum percentage the Applicant will be liable for is the pre-discount amount minus the funded amount or ineligible portion as shown on the form 471 Block 5.
- In the event of questions during the E-Rate PIA review process, the successful vendor is expected to reply within 3 days to questions associated with their proposal.
- The contractor is responsible for providing a valid SPIN (Service Provider Identification Number) at the time the bid is submitted.
- Any potential bidder found to be in Red-Light Status will be disqualified from participation in the bidding process and will be considered non-responsive.
- Vendor understands that they may be asked to work around school schedules to avoid impacting classroom or busy office times.

The Applicant reserves the right to deny any or all proposals associated with this RFP, even with SLD funding approval. Applicant reserves the right to consider existing piggyback, open RFP, open 470, etc....

Failure to follow the above criteria and requirements may be considered grounds for disqualification.

Proposals must be addressed to our office location noted below.

Superintendent
Creighton Community Schools
1609 Redick Ave.
Creighton, NE, 68729
Telephone: 402-358-5001

PROJECT

This proposal shall be broken down into two options:

1. Full proposal (hardware and labor together) to include:
 - a. Vendor to propose and coordinate configurations with the district prior to installation, in order to provide a "turn-key" delivery.
 - b. Install the specified network electronics equipment.
 - c. Install specified copper and fiber optics cabling.
 - d. Perform power-on system and functionality tests.
 - e. Perform and demonstrate a verification of network connectivity and functionality.
 - f. Verify access to the Internet and to district resources

- g. Provide documentation listing all equipment, part numbers, quantities, serial numbers, IP addressing and equipment naming.**
- h. Provide proposed coverage map and post install verification of coverage.**
- i. Provide necessary training as agreed upon by vendor and district.**
- j. Provide two year maintenance agreement on qualifying equipment.**

2. Hardware and labor separately to include:

- a. Delivery of each component to its designated secured location.**
- b. Provide documentation listing all equipment, part numbers, quantities, and serial numbers.**
- c. Provide two year maintenance agreement on qualifying equipment.**

HARDWARE EQUIPMENT

WIRELESS ACCESS POINT:

Each wireless access point should have a dual radio (antenna) design. Each access point should be able to provide at minimum 802.11a/b/g/n/ac standards within the 2.4GHz and 5GHz bands. Each access point should have at least one gigabit uplink port. Each access point should be able to provide 4 or more BSSID. Each access point should have the ability to be managed by a central system. Each access point should be compatible with current system unless all equipment is to be replaced. There should be at least one access point per room planned.

WIRELESS CONTROLLER SYSTEM:

The controller should be able to contact and control all currently or newly installed equipment. Two years of hardware and software support should cover the wireless access points and the wireless controller system or the system as a whole.

NETWORK CABLING:

All network wire should be Category 6 rated or better with compliant Category 6 accessories used. Installed should be a minimum of two cables per access point location. All cable runs should be terminated independently in a female connection form factor at each wireless access point location. If not already installed, fiber should be installed between distribution frames for network

backbone purposes. The fiber should be at minimum 3 pair in size and 10 Gigabit capable rated or better with compliant 10 Gigabit accessories used. If fiber is already installed but not 10 Gigabit rated, it should be replaced or supplemented with additional fiber that is 10 Gigabit rated.

NETWORK SWITCHING:

Must have such design to integrate seamlessly with existing head-end and downstream equipment. All distribution frames must have port density and fiber connectivity to support all backbone connections and current or newly terminated connections. All switches must provide at minimum 48 RJ45 Gigabit ports, 2 SFP+ ports, 802.3af/at PoE+ capabilities, and 740W or more total power.

CACHING SERVER:

Equipment must be able to provide a caching service for iOS updates for more than 100 iOS devices with a minimum of 1TB hard drive space.

UPS (UNINTERRUPTABLE POWER SUPPLY):

Each distribution frame must have a UPS with enough capacity to provide at least 30 min of runtime at the current equipment load.

RACK EQUIPMENT:

Rack equipment should support all proposed or current equipment. Depending on location will dictate size, form factor, and installation requirements.

Evaluation Procedures

The evaluation will be performed by the RFP Coordinator and evaluation staff for services proposed. The evaluators will consider how well the vendor's proposed solution meets the needs and criteria set forth in the fair and competitive bidding process using the below matrix. It is important that bids be itemized, clear, and complete so that the evaluators can adequately understand all aspects of the proposal. Evaluation results are confidential and the property of the district.

Evaluation Scale:

Factor	Weight
Price of Eligible Goods and Services	25%
Prior Experience	20%
Walkthrough	15%
Qualifications	10%
Deviance from RFP Specifications	10%
Distance from District	10%
Billing Methods	5%
E-rate Experience	5%

Creighton Community Public Schools Aerial View



Creighton Community Public Schools Floor Plan

CREIGHTON JR./SR. HIGH SCHOOL

Red = Exits
 Blue = Restrooms

FOOTBALL FIELD/TRACK

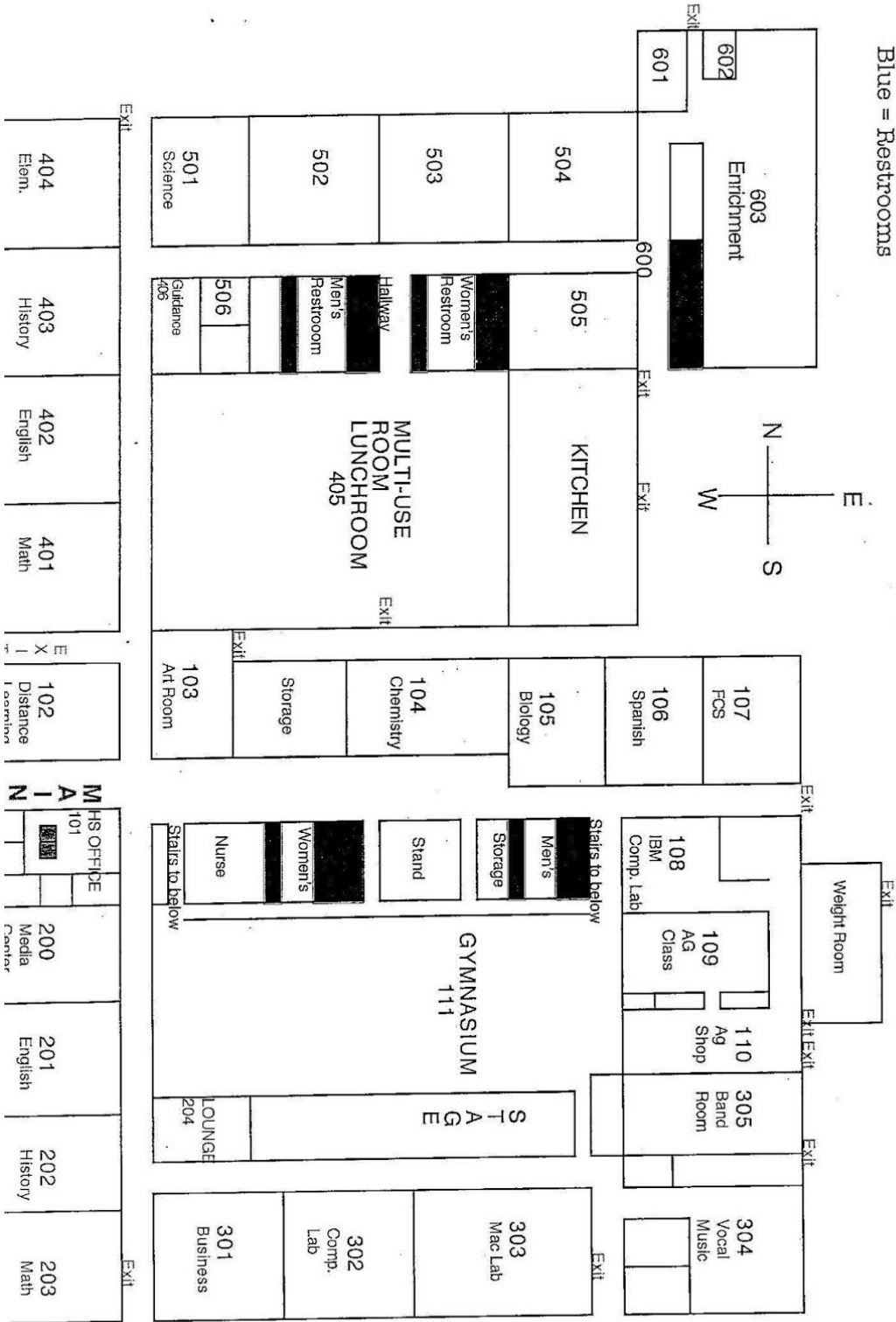

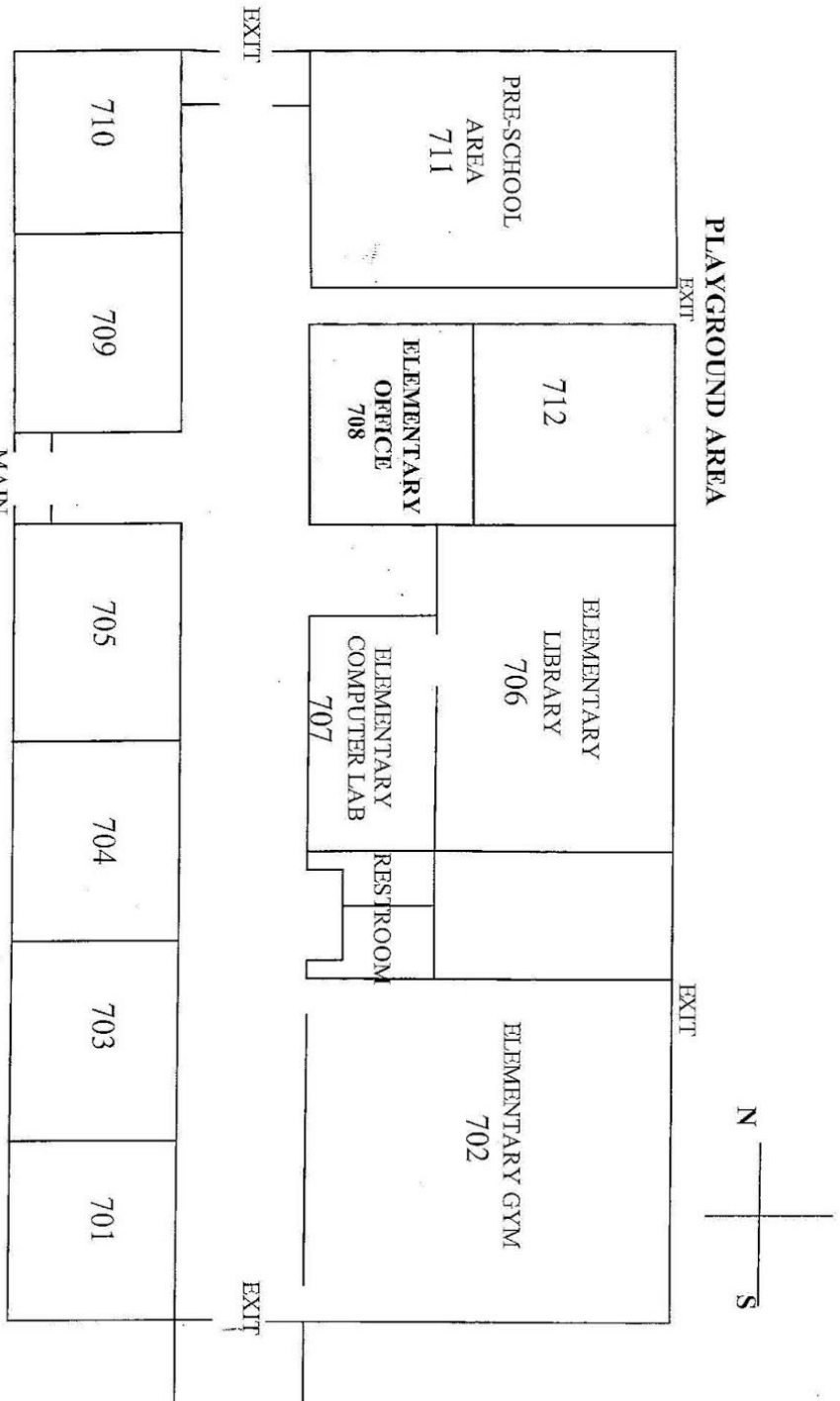

CREIGHTON ELEMENTARY SCHOOL